

END MILLS

B

B1 - B12

End Mills	B1 - B12
Series 1500 - One Flute End Mills for Soft Materials	B2
Series 1560 - One Flute End Mills for Flexible Laminates	B3
Series 1600 - Two Flute End Mills	B4
Series 1660 - Two Flute End Mills for Flexible Laminates	B6
Series 1730 - Three Flute Zero Helix No End style (Safe End) End Mills	B7
Series 1735 - Three Flute End Mills for Clean Edges	B8
Series 1800 - Four Flute End Mills	B11

Single Flute

Flexible Laminates End Mills

Diameter Range
0.0312" ~ 0.1250"

B
END MILLS

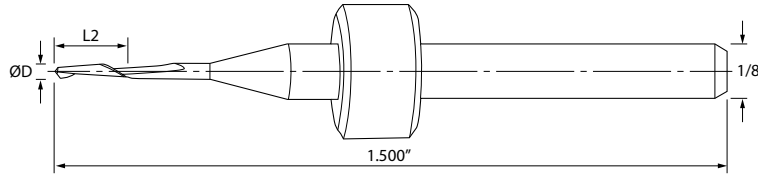

STANDARD Flute Length (Inch)

Part Number	Stock	End Mill Size	Dimensions (in)		Helix Angle	End Style
			Cutting Diameter	Flute Length		
			ØD	L2		
1500.0312.150D	●	1/32"	0.0312	0.1500	30°	Drill Point
1500.0625.200D	●	1/16"	0.0625	0.2000	30°	Drill Point
1500.0625.250	●	1/16"	0.0625	0.2500	30°	Square
1500.0938.375	●	3/32"	0.0938	0.3700	30°	Square
1500.1250.400	●	1/8"	0.1250	0.4000	30°	Square

Single flute end mill designed for routing or milling printed circuit boards, plexiglass, soft materials, or soft metals.

 Part Numbers above include rings set at 0.800" - For Ringless Part Number, replace series "." with "-" (XXX-XXXX.XXXX)
Additional diameters and special ring colors available upon request.

 For recommended cutting conditions please visit:
www.kyoceraprecisiontools.com/pcb/speeds-feeds

Single Flute

Flexible Laminates End Mills

Diameter Range
0.80mm ~ 2.00mm

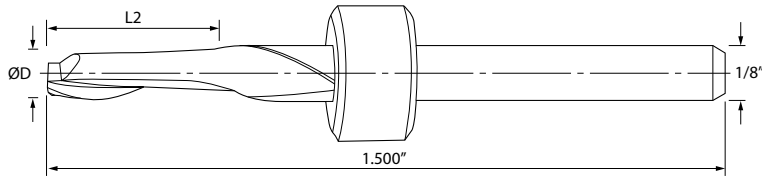

STANDARD Flute Length (Metric)



Part Number	Stock	End Mill Size	Dimensions (mm)		Helix Angle
			Cutting Diameter	Flute Length	
			ØD	L2	
1560.0315.094	●	0.80mm	0.800	2.39	30°
1560.0394.118	●	1.00mm	1.000	3.00	30°
1560.0472.142	●	1.20mm	1.200	3.61	30°
1560.0630.189	●	1.60mm	1.600	4.80	30°
1560.0787.236	●	2.00mm	2.000	6.00	30°



Single flute end mill designed for routing or milling flexible printed circuit boards, plexiglass, or soft materials.

DRILLS	A
END MILLS	B
ROUTERS	C
SCORING/ENGRAVING COUNTERSINKS	D
TECHNICAL	E
INDEX	F



Part Numbers above include rings set at 0.800" - For Ringless Part Number, replace series "." with "-" (XXX-XXXX.XXXX)
Additional diameters and special ring colors available upon request.



For recommended cutting conditions please visit:
www.kyoceraprecisiontools.com/pcb/speeds-feeds

Two Flute Square End Mills

Diameter Range
0.0312" ~ 0.1250"

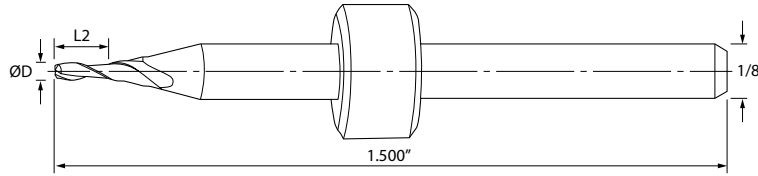

B
END MILLS

STANDARD Flute Length (Inch)



Part Number	Stock	End Mill Size	Dimensions (in)		Helix Angle
			Cutting Diameter	Flute Length	
			ØD	L2	
1600.0312.120	●	1/32"	0.0312	0.1200	30°
1600.0500.200	●	0.0500"	0.0500	0.2000	30°
1600.0625.250	●	1/16"	0.0625	0.2500	30°
1600.0938.390	●	3/32"	0.0938	0.3900	30°
1600.1250.500	●	1/8"	0.1250	0.5000	30°

Two flute end mill designed for routing or milling printed circuit boards, plexiglass, soft materials, or soft metals.

 Part Numbers above include rings set at 0.800" - For Ringless Part Number, replace series "." with "-" (XXX-XXXX.XXXX)
Additional diameters and special ring colors available upon request.

 For recommended cutting conditions please visit:
www.kyoceraprecisiontools.com/pcb/speeds-feeds

Two Flute Square End Mills

Diameter Range
0.30mm ~ 3.00mm

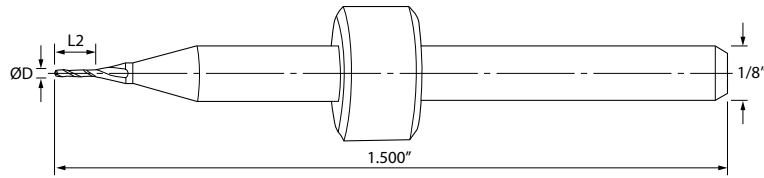

STANDARD Flute Length (Metric)



Part Number	Stock	End Mill Size	Dimensions (mm)		Helix Angle
			Cutting Diameter	Flute Length	
			ØD	L2	
1600.0118.045	●	0.30mm	0.300	1.14	30°
1600.0150.050	●	0.38mm	0.380	1.27	30°
1600.0157.079	●	0.40mm	0.400	2.00	30°
1600.0177.079	●	0.45mm	0.450	2.00	30°
1600.0197.079	●	0.50mm	0.500	2.00	30°
1600.0197.118	●	0.50mm	0.500	3.00	30°
1600.0236.079	●	0.60mm	0.600	2.00	30°
1600.0276.120	●	0.70mm	0.700	3.05	30°
1600.0315.120	●	0.80mm	0.800	3.05	30°
1600.0315.157	●	0.80mm	0.800	4.00	30°
1600.0354.120	●	0.90mm	0.900	3.05	30°
1600.0394.120	●	1.00mm	1.000	3.05	30°
1600.0394.200	●	1.00mm	1.000	5.08	30°
1600.0472.138	●	1.20mm	1.200	3.50	30°
1600.0472.210	●	1.20mm	1.200	5.33	30°
1600.0551.195	●	1.40mm	1.400	4.95	30°
1600.0630.250	●	1.60mm	1.600	6.35	30°
1600.0630.315	●	1.60mm	1.600	8.00	30°
1600.0787.340	●	2.00mm	2.000	8.64	30°
1600.0945.390	●	2.40mm	2.400	9.91	30°
1600.1181.500	●	3.00mm	3.000	12.70	30°



Two flute end mill designed for routing or milling printed circuit boards, plexiglass, soft materials, or soft metals.

DRILLS	A
END MILLS	B
ROUTERS	C
SCORING/ENGRAVING COUNTERSINKS	D
TECHNICAL	E
INDEX	F



Part Numbers above include rings set at 0.800" - For Ringless Part Number, replace series "." with "-" (XXX-XXXX.XXXX) Additional diameters and special ring colors available upon request.



For recommended cutting conditions please visit: www.kyoceraprecisiontools.com/pcb/speeds-feeds

Two Flute

Square Flexible Laminates End Mills

Diameter Range
0.80mm

B
END MILLS

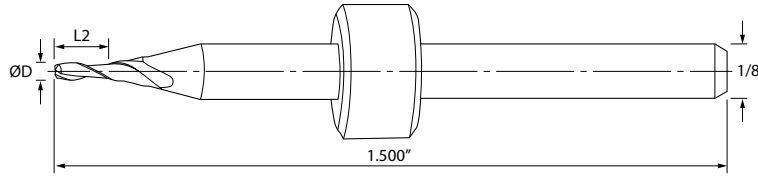

STANDARD Flute Length (Metric)

Part Number	Stock	End Mill Size	Dimensions (mm)		Helix Angle
			Cutting Diameter	Flute Length	
			ØD	L2	
1660.0315.093	●	0.80mm	0.800	2.36	30°
1660.0630.295	●	1.60mm	1.600	7.50	16°

Two flute end mill designed for routing or milling flexible printed circuit boards, plexiglass, or soft materials.

 Part Numbers above include rings set at 0.800" - For Ringless Part Number, replace series "." with "-" (XXX-XXXX.XXXX)
Additional diameters and special ring colors available upon request.

 For recommended cutting conditions please visit:
www.kyoceraprecisiontools.com/pcb/speeds-feeds

Three Flute Zero Helix End Mills

Diameter Range
0.80mm ~ 2.40mm

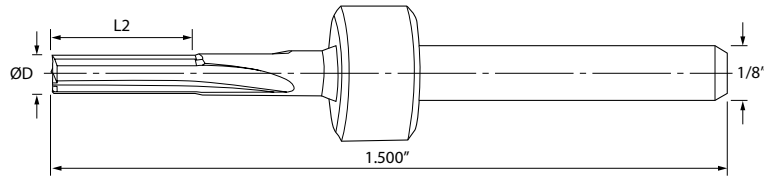

STANDARD Flute Length (Metric)



Part Number	Stock	End Mill Size	Dimensions (mm)		Helix Angle
			Cutting Diameter	Flute Length	
			ØD	L2	
1730.0315.120	●	0.80mm	0.800	3.05	0°
1730.0630.315	●	1.60mm	1.600	8.00	0°
1730.0945.394	●	2.40mm	2.400	10.00	0°



Three flute zero helix cutter designed for side routing printed circuit boards, gold tab connectors, soft materials, or soft metals.

DRILLS	A
END MILLS	B
ROUTERS	C
SCORING/ENGRAVING COUNTERSINKS	D
TECHNICAL	E
INDEX	F



Part Numbers above include rings set at 0.800" - For Ringless Part Number, replace series "." with "-" (XXX-XXXX.XXXX)
Additional diameters and special ring colors available upon request.



For recommended cutting conditions please visit:
www.kyoceraprecisiontools.com/pcb/speeds-feeds

Series 1735

Soft Laminate and
Fine Metal Edge End Mill



Designed for Ultra-fine Edge Finish

When flawless edges are required

Great for soft PCB laminate materials and metals

Capable of surface milling and plunging

Smooth edges and cleanly cut fibers

Does not require use of entry material



Series 1735

Soft Laminate and Fine Metal Edge End Mill

Series 1735 End Mills designed to provide an ultra-fine edge finish on soft PCB laminate materials and metals that require flawless edges. End Style allows surface milling and plunging.

Flex products, Aramid reinforced materials, PTFE, most soft materials, and gold fingers are prime examples of the challenges posed to PCB Fabrication Departments worldwide. In some cases, parameters can be adjusted with standard tools to address the rough edges, raised burrs, and/or fibers. There are, however, cases that require special tools and methods. Specific to these cases, Kyocera Precision Tools introduces an upgrade to the 1730 design with surface milling and plunging capabilities.

In addition, these tools generally eliminate the requirement of entry material that is sometimes needed on this type of work when using conventional cutters.

** This product requires specific processes and operating parameters.
For optimal results, please contact a Kyocera Precision Tools field engineer.*

Material: PTFE

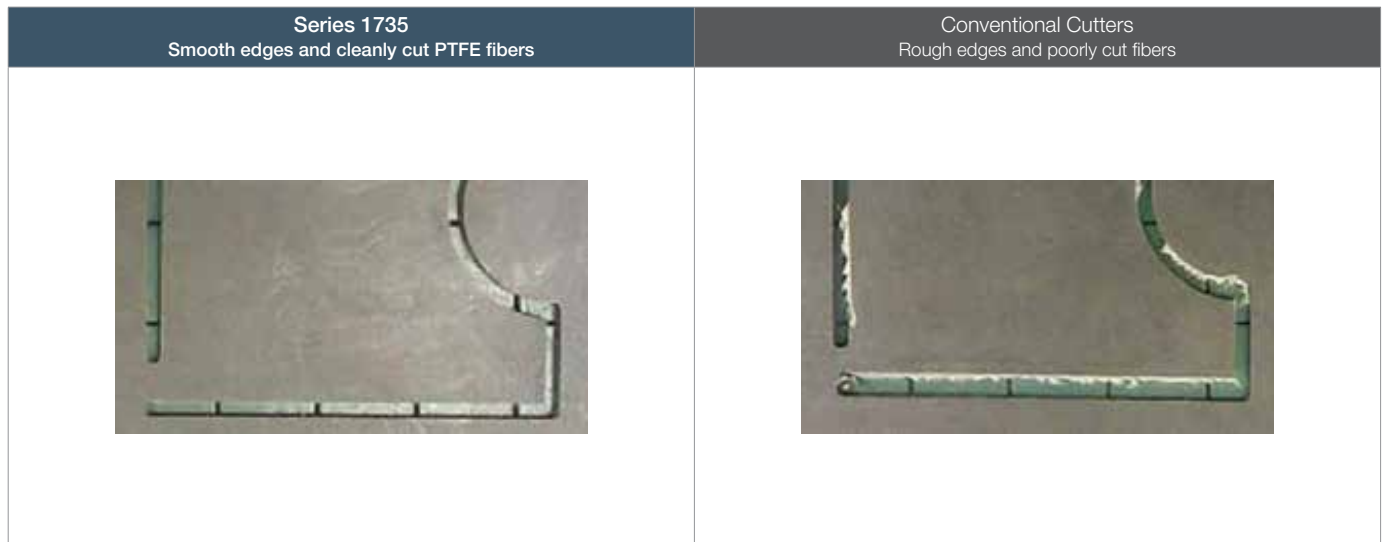

Material: Gold Tabs/Connectors



DRILLS	A
END MILLS	B
ROUTERS	C
SCORING/ENGRAVING COUNTERSINKS	D
TECHNICAL	E
INDEX	F

Three Flute

Square Flexible Laminates End Mills

Diameter Range
0.1250"
0.80mm ~ 2.40mm

B
 END MILLS



Three flute zero helix end mill designed for side routing or milling printed circuit boards, gold tab connectors, soft materials, or soft metals.

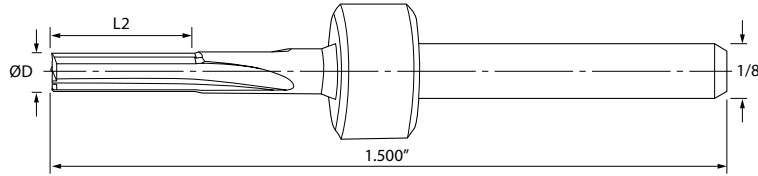

STANDARD Flute Length (Inch)



Part Number	Stock	End Mill Size	Dimensions (in)		Helix Angle
			Cutting Diameter	Flute Length	
			ØD	L2	
1735.1250.500	●	0.1250"	0.1250	0.5000	0°

STANDARD Flute Length (Metric)



Part Number	Stock	End Mill Size	Dimensions (mm)		Helix Angle
			Cutting Diameter	Flute Length	
			ØD	L2	
1735.0315.138	●	0.80mm	0.800	3.50	0°
1735.0630.315	●	1.60mm	1.600	8.00	0°
1735.0945.315	●	2.40mm	2.400	8.00	0°

Part Numbers above include rings set at 0.800" - For Ringless Part Number, replace series "." with "-" (XXX-XXXX.XXXX)
 Additional diameters and special ring colors available upon request.

For recommended cutting conditions please visit:
www.kyoceraprecisiontools.com/pcb/speeds-feeds

Four Flute Square End Mills

Diameter Range
0.0625" ~ 0.1250"

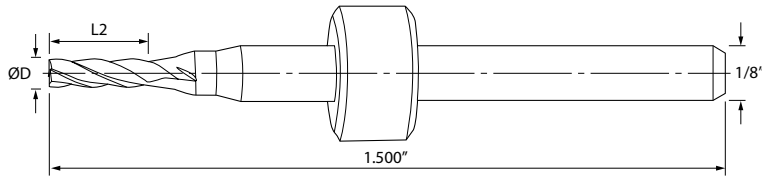

STANDARD Flute Length (Inch)



Part Number	Stock	End Mill Size	Dimensions (in)		Helix Angle
			Cutting Diameter	Flute Length	
			ØD	L2	
1800.0625.200	●	1/16"	0.0625	0.2000	30°
1800.0938.438	●	3/32"	0.0938	0.4380	30°
1800.1250.500	●	1/8"	0.1250	0.5000	30°



Four flute end mill designed for routing or milling printed circuit boards.

DRILLS	A
END MILLS	B
ROUTERS	C
SCORING/ENGRAVING COUNTERSINKS	D
TECHNICAL	E
INDEX	F



Part Numbers above include rings set at 0.800" - For Ringless Part Number, replace series "." with "-" (XXX-XXXX.XXXX)
Additional diameters and special ring colors available upon request.



For recommended cutting conditions please visit:
www.kyoceraprecisiontools.com/pcb/speeds-feeds